

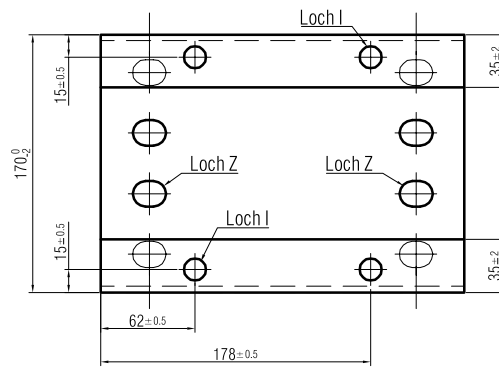

ASTRA  
OFROU  
USTRA  
UVIAS

# Richtlinie für Fahrzeugrückhaltesysteme

Ansicht C



Ansicht B

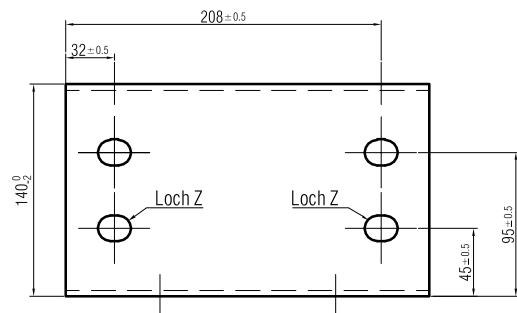

Ansicht A

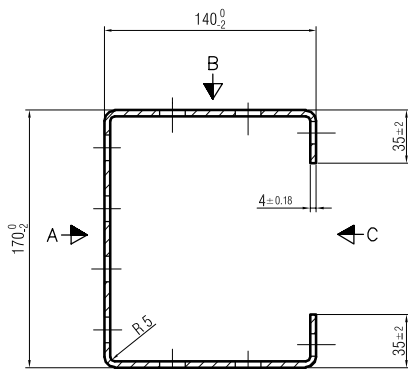
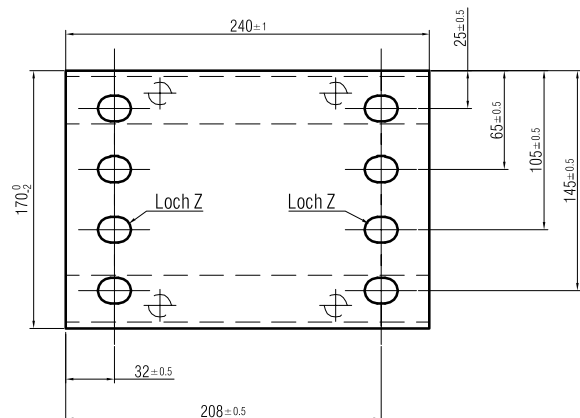

Detail Loch I

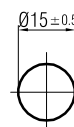

Detail Loch Z

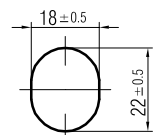

Stahlqualität	S235 JR G2	
Oberfläche	Feuerverzinkt nach EN ISO 1461	
Schweissnähte		
Masstab	Ausgabe	01.03.02
1 : 2	ersetzt	
1 : 5		
Zeichnung Nr.		
<b>D 411</b>		

Stossblech Kastenprofil 150'180